



Professional cranes & hoists for lifting



Electric Chain Hoist



CHENG DAY MACHINERY WORKS CO., LTD.



Electric Chain Hoist (Hook Suspension Type)

Motor Housing

- Aluminum alloy casting, features rigid structure and light weight.
- Motor framed with radiant cooling fins, permits 40% (dual speed 40/20%, YSF-series 15%) duty cycle.

Motor Brake

- "Electro-Magnetic Brake Controller" - a unique design in its field, R.O.C. Patent No. 27417 features simultaneous braking upon release of P.B. even under full load.

Limit Switch

- Fitted at both top and bottom ends, shuts off power automatically to prevent load chain from running out.

Load Chain

- Grade 80 case hardened alloy steel chain.

Hook

- Hot forged high tensile steel, rigid and durable, 360° swivel, fitting with safety latch to assure safe lifting.

Hoist Bracket

- Double high-tensile alloy steel plate bracket, features rugged and durable construction.

Mechanical Brake

- Advanced design, assures secure braking even under overload. In conjunction with motor brake, features "DOUBLE BRAKE SYSTEM" for safety and durability in hoist operation.

Transformer

- Power to pendant control reduced to 24V or 48V for safer operation.

Magnetic Contactor

- High performance non-fuse circuit breakers allow frequent trouble cycling with free operation.

Phase Error Relay

- A specially designed electric board prevents motor from running at it reverse phased.

Push Button Pendant

- Offers light and durable switching controls.

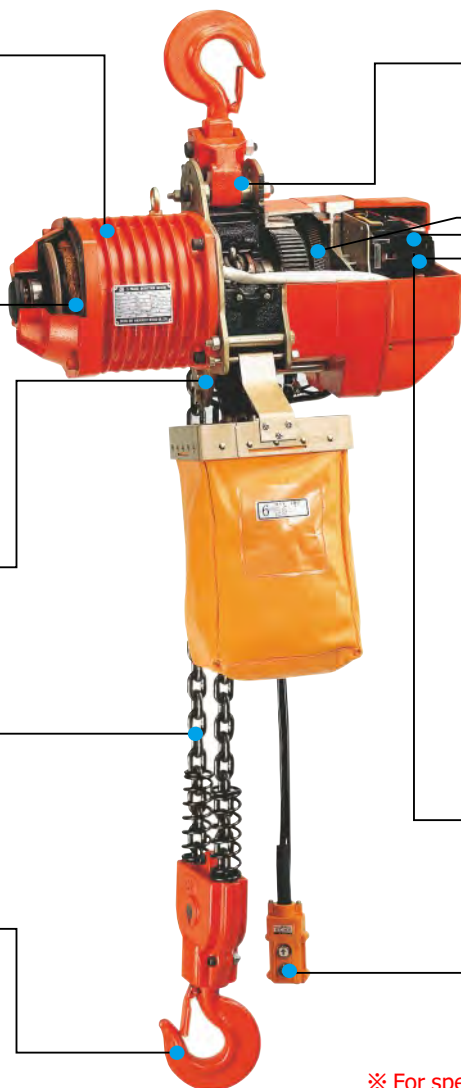

※ For special applications, please contact our company representative or authorized distributor.

Load Chain

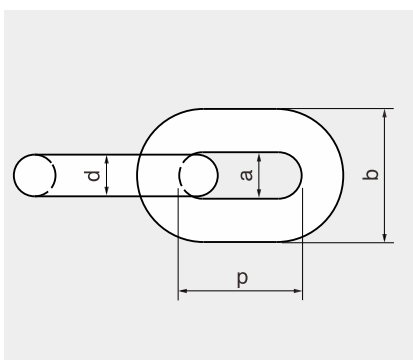

Diameter d(mm)	Model Reference Being Used	Inner Length p(mm)	Inner Width a(mm)	Outer Width b(mm)	Breaking Load (kn)
Φ7.1	050-300 YSE YSL YSF YSH YL(H)T	20.2	8.2	23.2	63
Φ10.0	YSS(T)-200 YSS(T)-300	30.2	12.5	33.2	128
Φ11.2	YSS(T)-250 YSS(T)-500 YSS-750 YSS-1000 YSS-1500 YSS-2000 YSS-3000	34.0	14.0	37.5	160

Hook

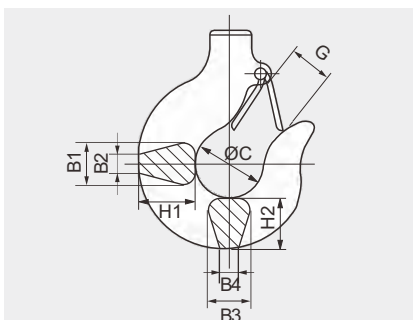

Model	Capacity (ton)	T B	Dimensions (mm)								Allow Stress (kg/mm ²)	Hook Block Weight (kg)
			H1	B1	B2	H2	B3	B4	C	G		
YSL,H,E,F	0.5,1	T B	33	23	9	29	23	9	40	28	70	*10
YSL,H,E,F	2	T B	45	31	10	41	31	10	46	36	70	*10
YSL,H	3	T B	55	34	19	48	34	19	52	40	70	*10
YSS	2,2.5,3	T B	55	34	19	48	34	19	52	40	70	*10
	5	T B	67	45	23	60	45	23	62	45	70	20
	7.5	B	75	48	16	68	48	16	75	55	100	40
	10	B	100	70	28	95	65	28	100	70	70	70
	15	B	120	85	32	110	83	32	120	82	70	140
	20	B	140	100	38	130	95	38	140	105	70	270
	30	B	140	98	38	130	94	38	140	105	100	350

● T=Top hook / B=Bottom hook ● If the weight is less than 10 kg, it will be considered as 10 kg.

■ Features of YSE Series:



- Direct connection to power supply.
- Slipping clutch provides overload protection.
- No limit switch nor limit spring, reduces headroom.
- Optional low voltage, 24 volt, control available.

Capacity (ton)	0.5			1	2
Lift Length (m)	3 (6) etc.				
Single Speed (m/min)	50Hz	6.7	4.7	2.3	
	60Hz	8.0	5.6	2.8	
Motor Power (kw)	1.5			1.8	
Power Supply	3 Phase, 220V-600V,50Hz,60Hz				
E.D Rating (%)	40				
Load Chain Fall Number	1			2	
N.W./G.W. (kg)	50.5/53			60.5/63	
Packing LXWXH (cm)	60X57X33				
Msrmnt (cu, ft)	4				

■ Features of YLT/YHT/YST Series:



- Specially engineered frame combines hoist and trolley, for specific low headroom applications.
- Reduced headroom provides higher lifting.

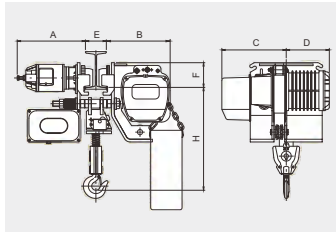

※YET(D) series of products are only applicable for Europe.
 ※Maximum lifting height : 6M

Model	Capacity (ton)	Dimension (mm)						Hoisting			Traversing			N.W. (kg)	
		H	A	B	C	D	E	F	Speed(m/min) 50Hz	60Hz	Motor kw pole	Speed(m/min) 50Hz	60Hz		Motor kw pole
YET-050	0.5	440	327	307	278	241	75-125	112	6.7	8.0	1.5, 4P	20	24	0.25, 4P	188
YETD-050						286			6.7/2.2	8.0/2.7	1.8/0.6, 4/12P	20/7	24/8	0.25/0.08, 4/12P	
YET-100	1	440	327	307	278	241	75-125	112	4.7	5.6	1.5, 4P	20	24	0.25, 4P	188
YETD-100						286			4.7/1.6	5.6/1.8	1.8/0.6, 4/12P	20/7	24/8	0.25/0.08, 4/12P	
YET-200	2	520	330	310	311	208	100-150	118	2.3	2.8	1.8, 4P	20	24	0.25, 4P	216
YETD-200						253			2.3/0.8	2.8/1.0	1.8/0.6, 4/12P	20/7	24/8	0.25/0.08, 4/12P	
YET-300	3	593	366	315	343	208	125-175	143	1.5	1.8	1.8, 4P	20	24	0.6, 4P	277
YETD-300						221			1.5/0.5	1.8/0.6	1.8/0.6, 4/12P	20/7	24/8	0.6/0.2, 4/12P	
YLT-050	0.5	440	327	307	278	241	75-125	112	6.7	8.0	1.5, 4P	20	24	0.25, 4P	188
YLT-100	1	440	327	307	278	241			6.7/2.2	8.0/2.7	1.8/0.6, 4/12P	20/7	24/8	0.25/0.08, 4/12P	
YLT-200	2	520	330	310	311	208	100-150	118	2.3	2.8	1.8, 4P	20	24	0.25, 4P	216
YLT-300	3	593	366	315	343	208			2.3/0.8	2.8/1.0	1.8/0.6, 4/12P	20/7	24/8	0.25/0.08, 4/12P	
YHT-050	0.5	440	327	307	278	241	75-125	112	9.2	11	1.8, 4P	20	24	0.25, 4P	188
YHTD-050						286			9.2/3.1	11/3.7	1.8/0.6, 4/12P	20/7	24/8	0.25/0.08, 4/12P	
YHT-100	1	440	327	307	278	241	75-125	112	6.7	8.0	1.8, 4P	20	24	0.25, 4P	188
YHTD-100						286			6.7/2.2	8.0/2.7	1.8/0.6, 4/12P	20/7	24/8	0.25/0.08, 4/12P	
YHT-200	2	520	330	310	311	208	100-150	118	3.3	4.0	1.8, 4P	20	24	0.25, 4P	216
YHTD-200						253			3.3/1.1	4.0/1.3	1.8/0.6, 4/12P	20/7	24/8	0.25/0.08, 4/12P	
YHT-300	3	593	366	315	343	208	125-175	143	2.2	2.6	1.8, 4P	20	24	0.6, 4P	277
YHTD-300						221			2.2/0.7	2.6/0.9	1.8/0.6, 4/12P	20/7	24/8	0.6/0.2, 4/12P	
YST-200	2	702	371	443	318	319	125-175	143	6.7	7.9	3.7, 4P	20	24	0.6, 4P	438
YSTD-200						376			6.7/2.2	7.9/2.6	3.7/1.2, 4/12P	20/7	24/8	0.6/0.2, 4/12P	
YST-250	2.5	724	371	443	318	319	125-175	143	5.2	6.4	3.7, 4P	20	24	0.6, 4P	448
YSTD-250						376			5.2/1.7	6.4/2.1	3.7/1.2, 4/12P	20/7	24/8	0.6/0.2, 4/12P	
YST-300	3	765	371	443	274	363	125-175	143	4.3	5.2	3.7, 4P	20	24	0.6, 4P	465
YSTD-300						420			4.3/1.4	5.2/1.7	3.7/1.2, 4/12P	20/7	24/8	0.6/0.2, 4/12P	
YST-500	5	805	371	443	265	372	125-175	148	2.6	3.2	3.7, 4P	20	24	0.6, 4P	505
YSTD-500						429			2.6/0.9	3.2/1.0	3.7/1.2, 4/12P	20/7	24/8	0.6/0.2, 4/12P	

■ Dimensions of Hoist with Motorized Trolley

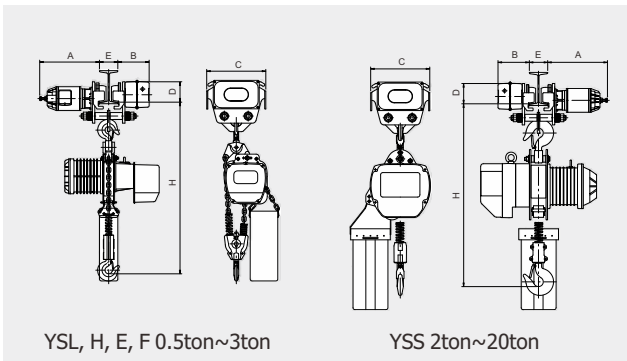

Capacity (ton)	Model	Dimensions(mm)						
		H	A	B	C	D	E	
YSL, H, E, YSF	0.5, 1	MT-050, 100	705	328	173	294	98	75-125
	2	MT-200	935	328	173	322	111	100-150
YSL, H	3	MT-300	1030	368	180	356	117	125-175
YSS	2	MT-200	995	328	173	322	111	100-150
	2.5	MT-300	1040	368	180	356	117	125-175
	3	MT-300	1120	368	180	356	117	125-175
	5	MT-500	1200	372	184	386	127	125-175
	7.5	MT-750	1300	381	193	454	167	150-200
	10	MT-1000	1415	471	193	560	205	150-200
15	MT-1500	1490	576	212	702	220	190	
20	MT-2000	1820	705	211	882	295	200	

■ Dimensions of Hoist with GT/PT

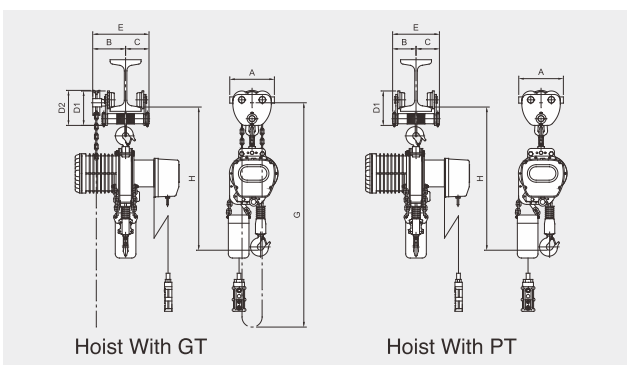

Capacity (ton)	Model	Dimensions(mm)								Flange Width (mm)	
		H	A	B	C	D1	D2	E	G		
YSL,H, YSE,F	0.5	GT-050	710	194	156	110	151	150	266	2709	50-150
	0.5	PT-050	710	194	110	110	151	-	220	-	50-150
	1	GT-100	720	217	160	113.5	170	167	273	2719	75-150
	1	PT-100	720	217	113.5	113.5	167	-	227	-	75-150
	2	GT-200	920	247	179	130	224	207	309	3279	100-175
	2	PT-200	920	247	130	130	207	-	260	-	100-175
YSL,H	3	GT-300	1110	270	196	150	241	239	346	3353	100-200
	3	PT-300	1110	270	150	150	239	-	300	-	100-200
YSS	2	GT-200	1010	247	179	130	224	207	309	3279	100-175
	2	PT-200	1010	247	130	130	207	-	260	-	100-175
	2.5	GT-300	1100	270	196	150	241	239	346	3353	100-200
	2.5	PT-300	1100	270	150	150	239	-	300	-	100-200
	3	GT-300	1175	270	196	150	241	239	346	3353	100-200
	3	PT-300	1175	270	150	150	239	-	300	-	100-200
	5	GT-500	1250	310	198	152	235	251	350	3356	125-200
	5	PT-500	1250	310	151	152	251	-	304	-	125-200

■ 0.5T, 1T



■ 2T



■ 3T



■ 2T



■ 2.5T



■ 3T



■ 5T



■ Features of Hoist:

- Pendant control voltage transformed into 24V/48V to eliminate possible accident caused by circuit short and assure safe operation in wet environments.
- Automatic motor brake system features simultaneous braking upon power failure or switching off.
- Dual brake system assures safe operation.

■ Specifications:

Capacity (ton)		0.5	1	2	0.5	1	2	0.5	1	2	3	2	2.5	3	5	7.5	10	15	20	30													
Lift Height (m)		3 (6) etc.																															
Load Chain (mm)		Φ7.1			Φ7.1			Φ7.1					Φ10	Φ11.2	Φ10	Φ11.2																	
Single Speed (m/min)	50Hz	YSF	5.6	3.9	2.0	6.7	4.7	2.3	-	-	-	-	-	-	-	-	-	-	-	-	-	-											
		YSL	-	-	-	-	-	-	6.7	4.7	2.3	1.5	-	-	-	-	-	-	-	-	-	-											
		YSH	-	-	-	-	-	-	(9.2)	(6.7)	3.3	2.2	-	-	-	-	-	-	-	-	-	-											
		YSS	-	-	-	-	-	-	-	-	-	-	6.6	5.2	4.3	2.6	1.8	2.6	1.8	1.3	0.9												
	60Hz	YSF	6.7	4.7	2.3	8.0	5.6	2.8	-	-	-	-	-	-	-	-	-	-	-	-	-	-											
		YSL	-	-	-	-	-	-	8.0	5.6	2.8	1.8	-	-	-	-	-	-	-	-	-	-											
		YSH	-	-	-	-	-	-	(11.0)	(8.0)	4.0	2.6	-	-	-	-	-	-	-	-	-	-											
		YSS	-	-	-	-	-	-	-	-	-	-	7.9	6.4	5.2	3.2	2.1	3.2	2.1	1.5	1.1												
Dual Speed (m/min)	50Hz	YSLD	-	-	-	-	-	6.7/2.2	4.7/1.6	2.3/0.8	1.5/0.5	-	-	-	-	-	-	-	-	-	-												
		YSHD	-	-	-	-	-	9.2/3.1	6.7/2.2	3.3/1.1	2.2/0.7	-	-	-	-	-	-	-	-	-	-												
		YSSD	-	-	-	-	-	-	-	-	-	-	6.6/2.2	5.2/1.7	4.3/1.4	2.6/0.9	1.8/0.6	2.6/0.9	1.8/0.6	1.3/0.43	0.9/0.3												
	60Hz	YSLD	-	-	-	-	-	8.0/2.7	5.6/1.8	2.8/1.0	1.8/0.6	-	-	-	-	-	-	-	-	-	-												
		YSHD	-	-	-	-	-	11.0/3.7	8.0/2.7	4.0/1.3	2.6/0.9	-	-	-	-	-	-	-	-	-	-												
		YSSD	-	-	-	-	-	-	-	-	-	-	7.9/2.6	6.4/2.0	5.2/1.7	3.2/1.0	2.1/0.7	3.2/1.0	2.1/0.7	1.5/0.5	1.1/0.4												
Motor (kw) (single speed)		1.8			1.8			1.5(1.8)		1.8		3.7					3.7X2		5.0X2														
Motor (kw) (dual speed)		-			-			1.8/0.6					3.7/1.2					3.7/1.2X2		5.0/1.7X2													
Power Supply		Single Phase 110V, 115V			Single Phase 220V, 230V			3 Phase, 220V- 600V					3 Phase, 220V- 600V																				
E.D. Rating (%)		15			15			40					40																				
Load Chain Fall Number		1	2	1	2	1	2	3	1	2	3	1	2	3	4	6	8	12															
N.W./G.W. (kg)		55/58.5		64.5/67		55/58.5		65/67		50.5/53		61/64		73/96		125/155		130/160		140/170		153/183		195/230		410/470		510/580		890/990		1035/1135	
Packing LXWXH (cm)		60X57X33			60X57X33			60X57X33					62X52X50		73X57X51					73X70X70		86X80X75		140X85X97		170X105X167		175X110X185					
Msrmt (Cu.ft)		4			4			4					5.7		7.5					12.63		18.23		40.8		105.3		125.8					

※Dual speed E.D. Rating = 40/20%

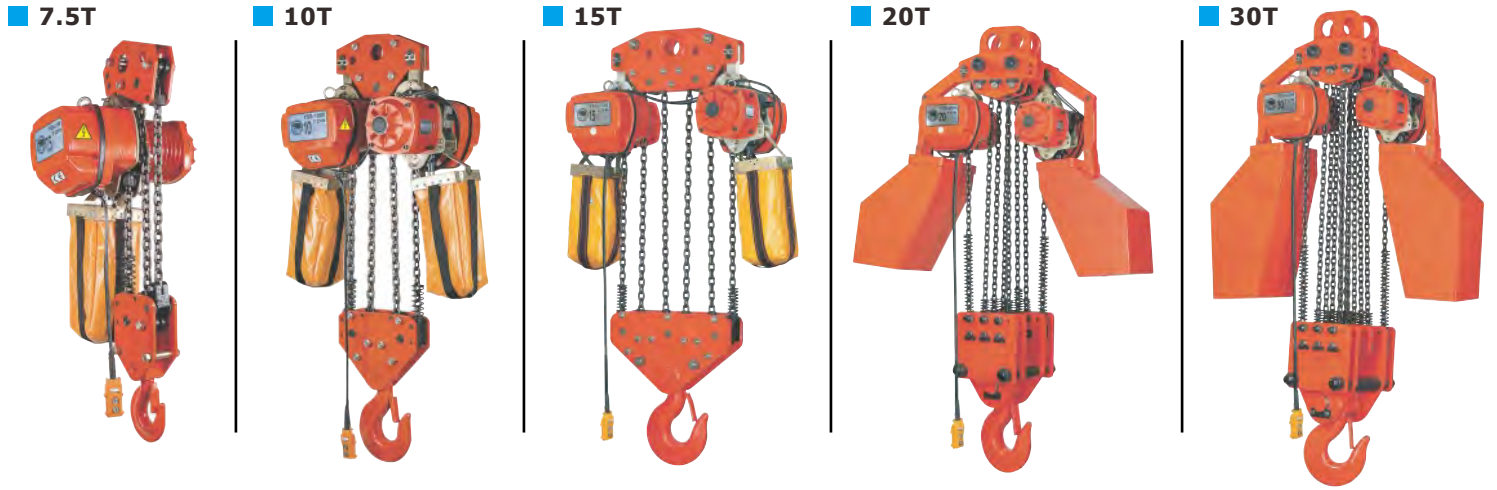

- Limit switches hold load chain from running out.
- Advanced phase error relay keeps motor motionless at incorrect power connection.
- Optional emergency stop features available.
- Optional electronic overload protection available.

■ Specifications:

Capacity (ton)	Model	Dimensions (mm)																			
		H		A				B				C	D	E	F	I	J	K	L	M	N
0.5	YSL, H, E, F-050	595	E560	505	F548	LD548	HD548	245	F288	LD288	HD288	260	240	115	125	40	28	40	28	23	23
1	YSL, H, E, F-100	595	E560	505	F548	LD548	HD548	245	F288	LD288	HD288	260	240	115	125	40	28	40	28	23	23
2	YSL, H, E, F-200	745	E710	505	F548	LD548	HD548	245	F288	LD288	HD288	260	240	175	65	46	36	46	36	31	31
3	YSL, H-300	880	-	505	-	LD548	HD548	245	-	LD288	HD288	260	280	175	105	52	43	52	43	34	34
2	YSS-200	835	-	640	-	-	SD689	326	-	-	SD375	314	448	278	170	52	43	52	43	34	34
2.5	YSS-250	880	-	640	-	-	SD689	326	-	-	SD375	314	448	278	170	52	43	52	43	34	34
3	YSS-300	960	-	640	-	-	SD689	326	-	-	SD375	314	448	340	108	52	43	52	43	34	34
5	YSS-500	1030	-	640	-	-	SD689	326	-	-	SD375	314	448	356	92	62	45	62	45	45	45
7.5	YSS-750	1150	-	640	-	-	SD689	326	-	-	SD375	314	587	388	199	72	40	75	57	84	48
10	YSS-1000	1270	-	640	-	-	SD689	326	-	-	SD375	314	970	485	485	72	40	100	68	92	60
15	YSS-1500	1365	-	679	-	-	SD724	365	-	-	SD410	314	1360	680	680	80	40	120	90	169	85
20	YSS-2000	1950	-	866	-	-	SD866	433	-	-	SD433	433	1472	736	736	82	82	140	95	164	95
30	YSS-3000	2000	-	924	-	-	SD924	462	-	-	SD462	462	1472	736	736	92	92	140	95	221	95

■ Dimensions of Hook Suspension Type Hoist:

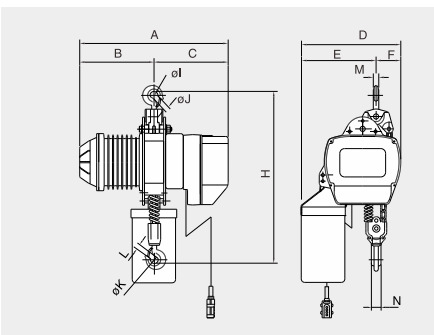

YSL, YSH, YSE, YSF, YSS

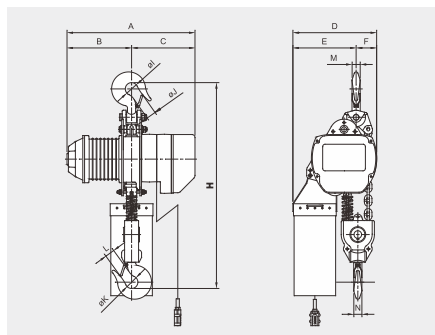

YSS-500

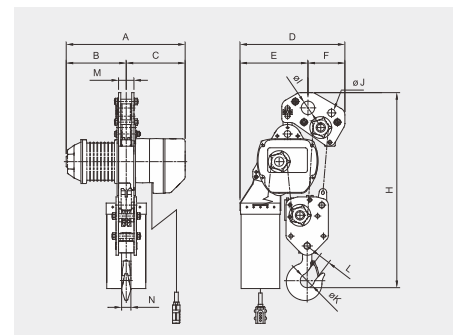

YSS-750

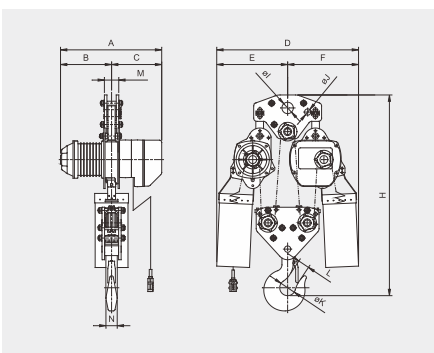

YSS-1000

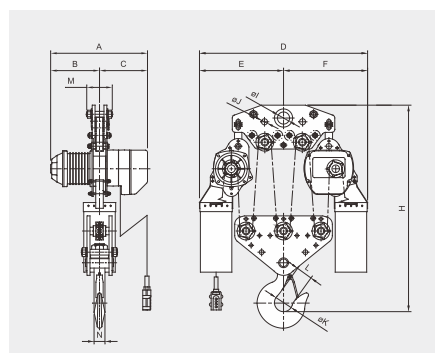

YSS-1500

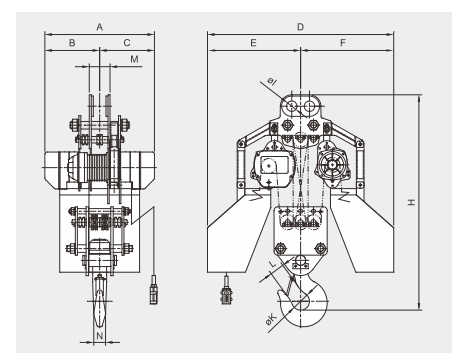

YSS-2000, YSS-3000

Trolley

● Plain Trolley (PT)

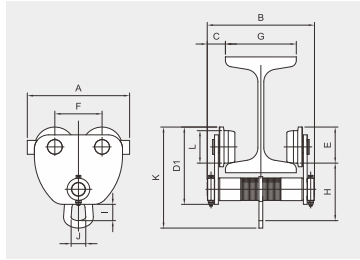

Dimensions (mm)															
Capacity (ton)	Model	A	B	C	D1	E	F	H	I	J	K	L	Flange Width G	N.W. (kg)	Min radius of curve (m)
0.5	PT-050	194	220	35	151	69	89	115	33	28	198	60	50-150	6.4	1.0m
1	PT-100	217	227	39	167	78	100	124	35	31	218	70	75-150	10.6	1.0m
2	PT-200	247	260	43	207	91	116	171	55	56	284	80	100-175	16.8	1.3m
3	PT-300	270	300	50	239	103	130	215	79	60	353	90	100-200	25.8	1.5m
5	PT-500	310	304	52	251	117	140	218	84	60	370	100	125-200	32.6	1.6m
7.5	PT-750	368	343	72	292	135	184	260	103	76	435	120	150-200	59.5	2.2m
10	PT-1000	398	350	75	322	152	197	275	105	76	467	140	150-200	81.4	2.2m

● Geared Trolley (GT)

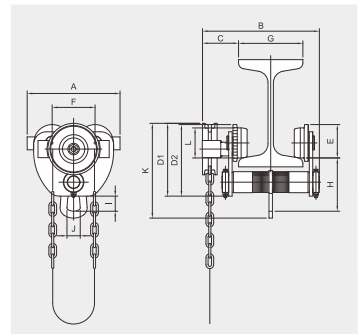

Dimensions (mm)																
Capacity (ton)	Model	A	B	C	D1	D2	E	F	H	I	J	K	L	Flange Width G	N.W. (kg)	Min radius of curve (m)
0.5	GT-050	194	266	81	150	151	69	89	115	33	28	198	60	50-150	8.8	1.0m
1	GT-100	217	273	85	170	167	78	100	124	35	31	221	70	75-150	13.5	1.0m
2	GT-200	247	309	91	224	207	91	116	171	55	56	301	80	100-175	19.8	1.3m
3	GT-300	270	346	96	241	239	103	130	215	79	60	355	90	100-200	30.3	1.5m
5	GT-500	310	350	98	235	251	117	140	218	84	60	370	100	125-200	37	1.6m
7.5	GT-750	368	382	110	280	292	135	184	260	103	76	435	120	150-200	64	2.2m
10	GT-1000	398	389	114	301	322	152	197	275	105	76	467	140	150-200	86	2.2m

● Monorail Motorized Trolley (MT)

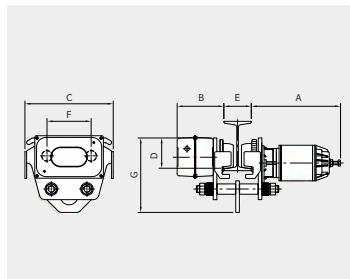

Dimensions (mm)														
Capacity (ton)	Model	A	B	C	D	E	F	G	Speed(m/min)		Motor (kw)	Pole (P)	Min radius of curve (m)	N.W. (kg)
									50Hz	60Hz				
1	MT-100	328	173	294	98	75-125	149	246	20	24, 16	0.25, 0.17	4, 6	1.3	40
	20/7								24/8					
2	MT-200	328	173	322	111	100-150	161	272	20	24, 16	0.25, 0.17	4, 6	1.5	45
	20/7								24/8					
3	MT-300	368	180	356	117	125-175	172	297	20	24, 16	0.6, 0.4	4, 6	1.8	65
	20/7								24/8					
5	MT-500	372	184	386	127	125-175	183	320	20	24, 16	0.6, 0.4	4, 6	2.0	89
	20/7								24/8					
7.5	MT-750	380	193	454	167	150-200	229	400	13	16	0.9	6	3.0	155
	13/6.5								16/8					
10	MT-1000	471	193	560	205	150-200	278	450	15	18	1.5	4	3.5	218
	15/5								18/6					
15	MT-1500	576	212	702	220	190	360	520	12	14	1.5	4	-	350
	12/4								14/4.6					
20	MT-2000	705	211	882	295	200	440	604	12	15	2.2	4	-	575
	12/4								15/5					

MT-100~500: 50Hz uses 4P motor ; 60Hz uses 4P or 6P motor
(Please specify as ordering 6P motor)

● Motor Saddle Trolley (MST)

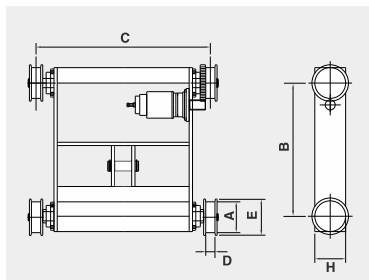
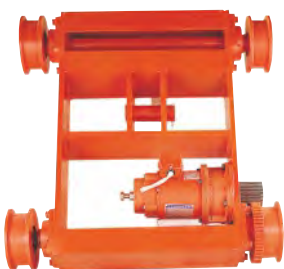

Dimensions (mm)												
Capacity (ton)	Model	Speed(m/min)		A	B	C	D	E	H	Motor (kw)	Pole (P)	N.W. (kg)
		50Hz	60Hz									
1	MST-100	20	19	120	580	700	40	147	122.5	0.25	4	94
	MSTD-100	20/6.7	19/6.3									
2	MST-200	20	19	120	580	700	40	147	122.5	0.25	4	94
	MSTD-200	20/6.7	19/6.3									
3	MST-300	18	22	150	650	850	45	178	155	0.4	4	182
	MSTD-300	18/6	22/7.3									
5	MST-500	18	22	150	650	850	45	178	155	0.6	6	182
	MSTD-500	18/9	22/11									
7.5	MST-750	19	23	160	800	1000	50	187	225	0.9	4	306
	MSTD-750	19/6.3	23/7.7									
10	MST-1000	21	20	215	900	1200	50	246	327.5	0.9-2pcs	4	504
	MSTD-1000	21/7	20/6.7									

MST-100 — 50Hz with pinion of M3.5x15T
MST-200 — 60Hz with pinion of M3.5x12T
MST-1000 — 50Hz/60Hz with pinion of M3.5x13T
MST-500 — 50Hz/60Hz with pinion of M3.5x20T
MST-750 — 50Hz/60Hz with pinion of M3.5x15T

Models Available

Capacity (ton)		0.5T	1T	2T	2.5T	3T	5T	7.5T	10T	15T	20T	30T	
3 Phase	Slipping Clutch	YSE	YSE-050	YSE-100	YSE-200								
	Low Speed	YSL	YSL-050	YSL-100	YSL-200		YSL-300						
			YLT-050	YLT-100	YLT-200		YLT-300						
	High Speed	YSH	YSH-050	YSH-100	YSH-200		YSH-300						
			YHT-050	YHT-100	YHT-200		YHT-300						
	Heavy Speed	YSS			YSS-200	YSS-250	YSS-300	YSS-500	YSS-750	YSS-1000	YSS-1500	YSS-2000	YSS-3000
			YST			YST-200	YST-250	YST-300	YST-500				
	Dual Speed	YSED	YSED-050	YSED-100	YSED-200								
		YSLD	YSLD-050	YSLD-100	YSLD-200		YSLD-300						
		YLTD	YLTD-050	YLTD-100	YLTD-200		YLTD-300						
		YSHD	YSHD-050	YSHD-100	YSHD-200		YSHD-300						
		YHTD	YHTD-050	YHTD-100	YHTD-200		YHTD-300						
		YSSD			YSSD-200	YSSD-250	YSSD-300	YSSD-500	YSSD-750	YSSD-1000	YSSD-1500	YSSD-2000	YSSD-3000
YSTD				YSTD-200	YSTD-250	YSTD-300	YSTD-500						
Single Phase	YSF	YSF-050	YSF-100	YSF-200									

Chain Bucket No. Selection Table

Model	Chain size (mm)	Lift (m)																								Bucket No.	Bucket size (mm)	Material				
		≤4	≤5	≤6	≤6	≤7	≤8	≤9	≤9	≤10	≤12	≤13	≤15	≤16	≤18	≤19	≤20	≤23	≤25	≤26	≤27	≤30	≤31	≤38	≤40				≤47	≤50	≤60	
YSF-050 YSE(D)-050 YSL(D)-050 YSH(D)-050	Φ7.1						#2						#3			#5-1	#4							#5-3		#5-4		#5-5	#5-6	#2	150X100X380L	canvas
YSF-100 YSE(D)-100 YSL(D)-100 YSH(D)-100	Φ7.1						#2						#3			#5-1	#4							#5-3		#5-4		#5-5	#5-6	#3	150X100X470L	canvas
YSF-200 YSE(D)-200 YSL(D)-200 YSH(D)-200	Φ7.1	#2	#3																											#4	150X100X560L	canvas
YSL(D)-300 YSH(D)-300	Φ7.1	#3	#4	#5-1			#5-2																							#5-1	210X140X465L	steel
YSS(D)-200	Φ10.0						#6																							#5-2	210X160X545L	steel
YSS(D)-250	Φ11.2						#6									#7	#8-1													#5-3	210X160X665L	steel
YSS(D)-300	Φ10.0	#6										#7	#8-1	#8		#9														#5-4	210X170X815L	steel
YSS(D)-500	Φ11.2	#6					#7	#8-1				#8	#9			#10														#5-5	210X170X975L	steel
YSS(D)-750	Φ11.2		#7	#8-1			#8	#9				#9	#10			#10														#5-6	210X180X1135L	steel
YSS(D)-1000	Φ11.2						#7	#8-1				#8	#9			#10														#6	190X190X440L	canvas
YSS(D)-1500	Φ11.2		#7	#8-1			#8	#9				#9	#10			#10														#7	190X190X560L	canvas
YSS(D)-2000	Φ11.2						#12					#13																		#8	190X190X680L	canvas
YSS(D)-3000	Φ11.2	#12					#13																							#8-1	400X210X605L	steel
																														#9	400X210X695L	steel
																														#10	400X210X770L	steel
																														#11	400X210X1105L	steel
																														#12	400X500X660L	steel
																														#13	400X500X867L	steel

* There are 2 chain bucket with hoist above 10 tons.

Power Supply :

- Electric Chain Hoists are available in all standard voltages of three Phase power, from 220V to 600V; as well as 115V or 230V of single Phase. Three Phase hoists are re-connectable.

Lifting Height :

- Standard lifting height: 3 Meters / 6 Meters.
- Optional height available upon request (may be charged extra according to load chain length).
- The balance trolley is available for lift height over 6M or steel chain bucket. (Optional)

Lifting Speed :

- Please refer to each detailed specification.

Standard Accessories :

- Chain container1pc
- Power cord3M
- Push button pendant (3M)1pc

Push Button Pendant :

- 2-button type: up and down.
- 4-button type: up and down; left and right (trolley).
- 6-button type: up and down; left and right; forward and reverse (end carrier).
- Plus standard emergency stop. (Optional)



Federation Europeenne De La Manutention

Load spectrum	Cubic mean value Definitions	Average operating time per day in hours							
		0.25-0.5	0.5-1	1-2	2-4	4-8	8-16	> 16	
1 (light)	($k \leq 0.50$) Mechanisms or parts thereof, usually subject to very small loads and in exceptional cases only to maximum loads.	0.25-0.5	0.5-1	1-2	2-4	4-8	8-16	> 16	
2 (medium)	($0.50 < k \leq 0.63$) Mechanisms or parts thereof, usually subject to small loads but rather often to maximum loads.	0.12-0.25	0.25-0.5	0.5-1	1-2	2-4	4-8	8-16	> 16
3 (heavy)	($0.63 < k \leq 0.80$) Mechanisms or parts thereof, usually subject to medium loads but frequently to maximum loads.	≤ 0.12	0.12-0.25	0.25-0.5	0.5-1	1-2	2-4	4-8	8-16
4 (very heavy)	($0.80 < k \leq 1$) Mechanisms or parts thereof, usually subject to maximum or almost to maximum loads.		≤ 0.12	0.12-0.25	0.25-0.5	0.5-1	1-2	2-4	4-8
Classification of Mechanisms FEM 9.511		1 Dm	1 Cm	1 Bm	1 Am	2 m	3 m	4 m	5 m

ISO/FEM (9.511)

Classification of mechanisms:

1 Dm	1 Cm	1 Bm	1 Am	2 m	3 m	4 m	5 m
M 1	M 2	M 3	M 4	M 5	M 6	M 7	M 8

Classification of mechanisms into groups:

Load spectrum	Cubic mean value	Class of operation time									
		V0.06	V0.12	V0.25	V0.5	V1	V2	V3	V4	V5	
		TO	T1	T2	T3	T4	T5	T6	T7	T8	
		Average operating time per day in hours									
		≤ 0.12	≤ 0.25	≤ 0.5	≤ 1	≤ 2	≤ 4	≤ 8	≤ 16	> 16	
1	L1	$k \leq 0.50$			1 Dm	1 Cm	1 Bm	1 Am	2 m	3 m	4 m
2	L2	$0.50 < k \leq 0.63$		1 Dm	1 Cm	1 Bm	1 Am	2 m	3 m	4 m	5 m
3	L3	$0.63 < k \leq 0.80$	1 Dm	1 Cm	1 Bm	1 Am	2 m	3 m	4 m	5 m	
4	L4	$0.80 < k \leq 1.00$	1 Cm	1 Bm	1 Am	2 m	3 m	4 m	5 m		

Class of operating time:

Class of operation time	Average operating time per day (in hours)	Calculated total operating time in hours
V0.06 T0	≤ 0.12	200
V0.12 T1	≤ 0.25	400
V0.25 T2	≤ 0.5	800
V0.5 T3	≤ 1	1600
V1 T4	≤ 2	3200
V2 T5	≤ 4	6300
V3 T6	≤ 8	12500
V4 T7	≤ 16	25000
V5 T8	> 16	50000

Operation Cycle

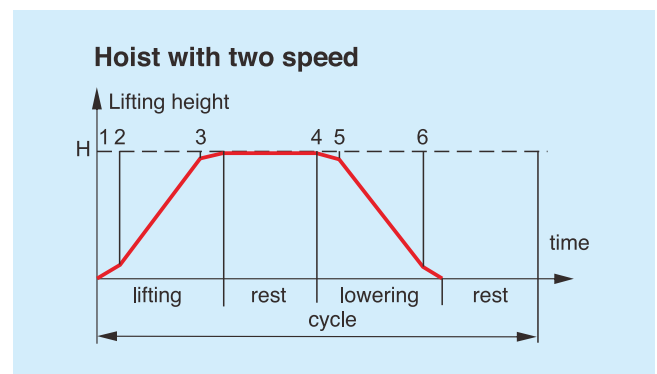
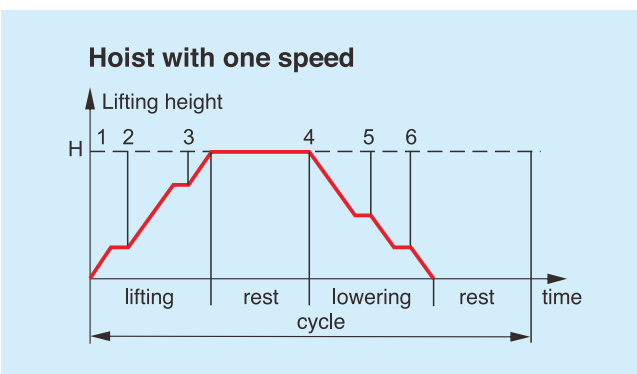

CHENG DAY MACHINERY WORKS CO., LTD.

No. 173, Wen Chiu Rd., Dajia Dist., Taichung City 437, Taiwan.

Tel: +886-4-2688-1581 Fax: +886-4-2688-1509

Website: www.chengday.com.tw E-mail: info@chengday.com.tw

- Revision of June, 2016 (Edition No.36) #950102
- No further notice while sizes and dimensions update; Quotations are based on practical dimensions.
- Due to the printing factors, the color of the products is subject to minor deviation from the physical objects.